



# INSTRUCTION BULLETIN

No. 328290  
Machine: T16  
Published: 06-2011  
Rev. 00

**NOTE: DO NOT DISCARD the Parts List from the Instruction Bulletin. Place the Parts List in the appropriate place in the machine manual for future reference. Retaining the Parts List will make it easier to reorder individual parts and will save the cost of ordering an entire kit.**

*NOTE: Numbers in parenthesis ( ) are reference numbers for parts listed in Bill of Materials.*

Installation instructions for **kit number 322310**

## SYNOPSIS:

This kit contains the parts needed to replace the steering chain on T16 scrubbers (**Serial Numbers 21953, 21958 - 22005, 22007 - 22027, 22029, 22032 and 22034 only**).

Please follow step-by-step instructions.

## SPECIAL TOOLS / CONSIDERATIONS: NONE

(Estimated time to complete: 45 minutes)



### PROTECT THE ENVIRONMENT

Please dispose of packaging materials, old machine components, and hazardous fluids in an environmentally safe manner according to local waste disposal regulations.

Always remember to recycle.

## PREPARATION: Standard machines and machines with side brush option only

1. Empty the solution and recovery tanks.
2. Park the machine on a clean level surface, turn off the machine, and remove the key.

**FOR SAFETY: Before leaving or servicing machine, stop on level surface, turn off machine, and remove key.**

3. Block the front and back of both rear tires.
4. Jack up the front end of the machine approximately 12" from the floor, position jack stands underneath the front of the machine, and lower the machine onto the jack stands. Refer to Fig. 1.

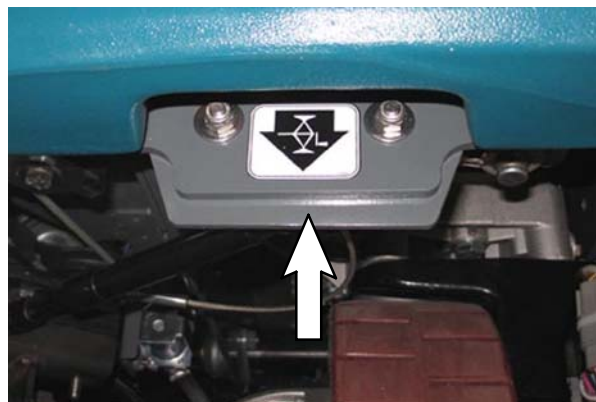

FIG. 1

**FOR SAFETY: When servicing machine, block machine tires before jacking machine up. Use a hoist or jack that will support the weight of the machine. Jack machine up at designated locations only. Support machine with jack stands.**

**PREPARATION: Machines with Pre-Sweep option only**

1. Empty the solution and recovery tanks.
2. Park the machine on a clean level surface, turn off the machine, and remove the key.

**FOR SAFETY: Before leaving or servicing machine, stop on level surface, turn off machine, and remove key.**

3. Block the front and back of both rear tires.
4. Remove the hopper from the Pre-Sweep assembly. Refer to the Operator Manual for instructions how to remove the hopper from the Pre-Sweep assembly.
5. Remove the brush from the Pre-Sweep assembly. Refer to the Operator Manual for instructions how to remove the brush from the Pre-Sweep assembly.
6. Center the jack underneath the Pre-Sweep frame and jack up the machine approximately 15" from the floor. Refer to Fig. 2.



**FIG. 2**

7. Place jack stands underneath the Pre-Sweep tube weldment where the weldment is attached to both sides of the Pre-Sweep frame and lower the machine onto the jack stands. Refer to Fig. 3.

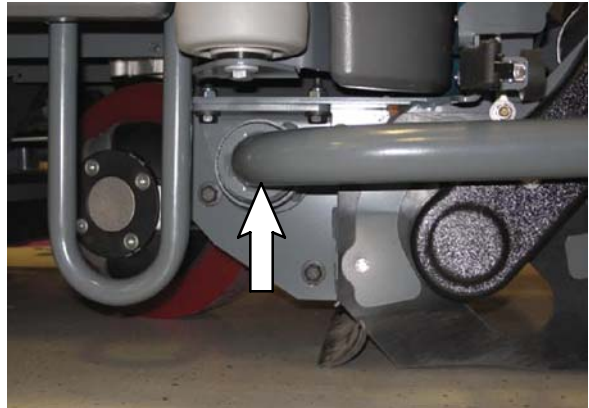

**FIG. 3**

**FOR SAFETY: When servicing machine, block machine tires before jacking machine up. Use a hoist or jack that will support the weight of the machine. Jack machine up at designated locations only. Support machine with jack stands.**

## INSPECTION:

Inspect the steering chain links for the stamped marking shown Fig. 5 and Fig. 6. Refer to Fig. 4 for location of chain on steering mechanism.

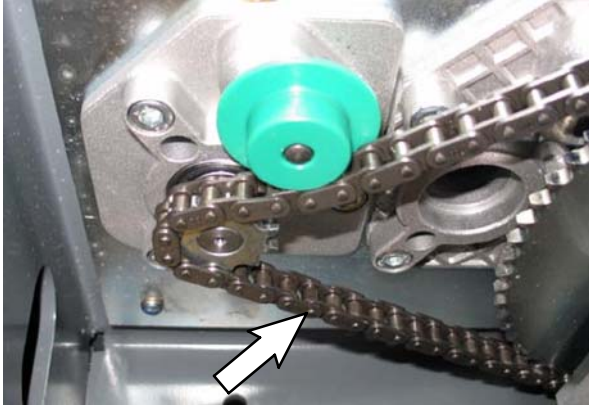

FIG. 4

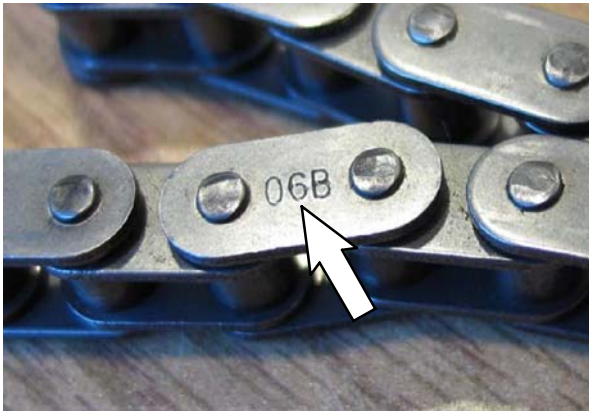

FIG. 5

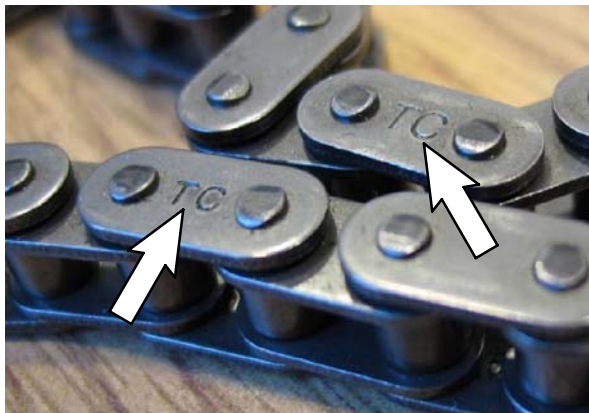

FIG. 6

If there are no stamps on the links, the steering chain does not need to be replaced. If the steering chain is stamped with **TC** or **06B** the chain must be replaced. Refer to Fig. 5 and Fig. 6. Proceed to the *INSTALLATION* section to replace the steering chain.

## INSTALLATION:

1. To ensure the steering wheel is properly aligned after the new chain is installed, turn the front wheel assembly counterclockwise until the wheel assembly hits the stop and can be turned no farther. Refer to Fig. 7.

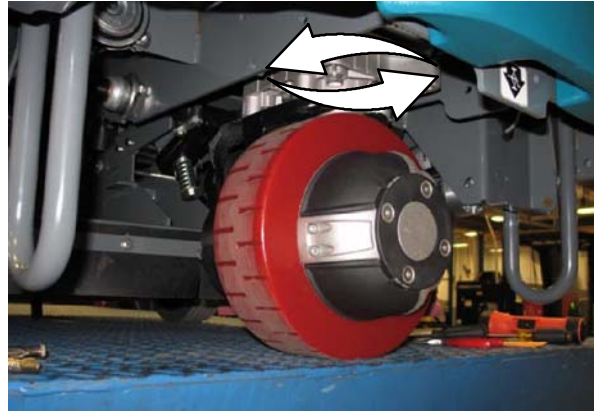

FIG. 7

2. Tape the steering wheel to secure it into the turned position so it does not move while the new chain is being installed. Refer to Fig. 8.



FIG. 8

3. Remove the master link from the chain. Refer to Fig. 9.



FIG. 9

*NOTE: Do not turn the small steering sprocket / steering wheel when removing the old steering chain / installing the new steering chain onto the steering mechanism. The steering wheel may not be properly aligned if the small steering sprocket / steering wheel are turned.*

4. Remove the chain from the steering sprockets. The tensioner pulley will fall from the steering mechanism when the steering chain is removed. Discard the steering chain and tensioner pulley. Refer to Fig. 10.

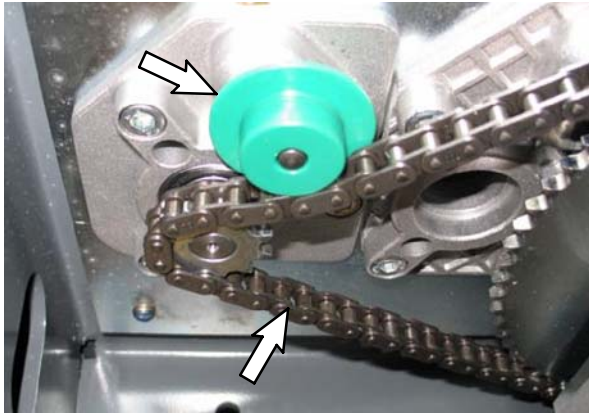

**FIG. 10**

5. Install the new chain onto the larger steering sprocket, route the chain around to the smaller sprocket, and back around to the larger sprocket.
6. Install the new smaller tensioner pulley onto the steering mechanism.
7. Position the two ends of the chain as close together as possible on teeth of the larger steering sprocket and use the new master link to connect the ends of the chain together. Be sure the tensioner pulley remains on the steering mechanism when master link is being installed onto the chain.

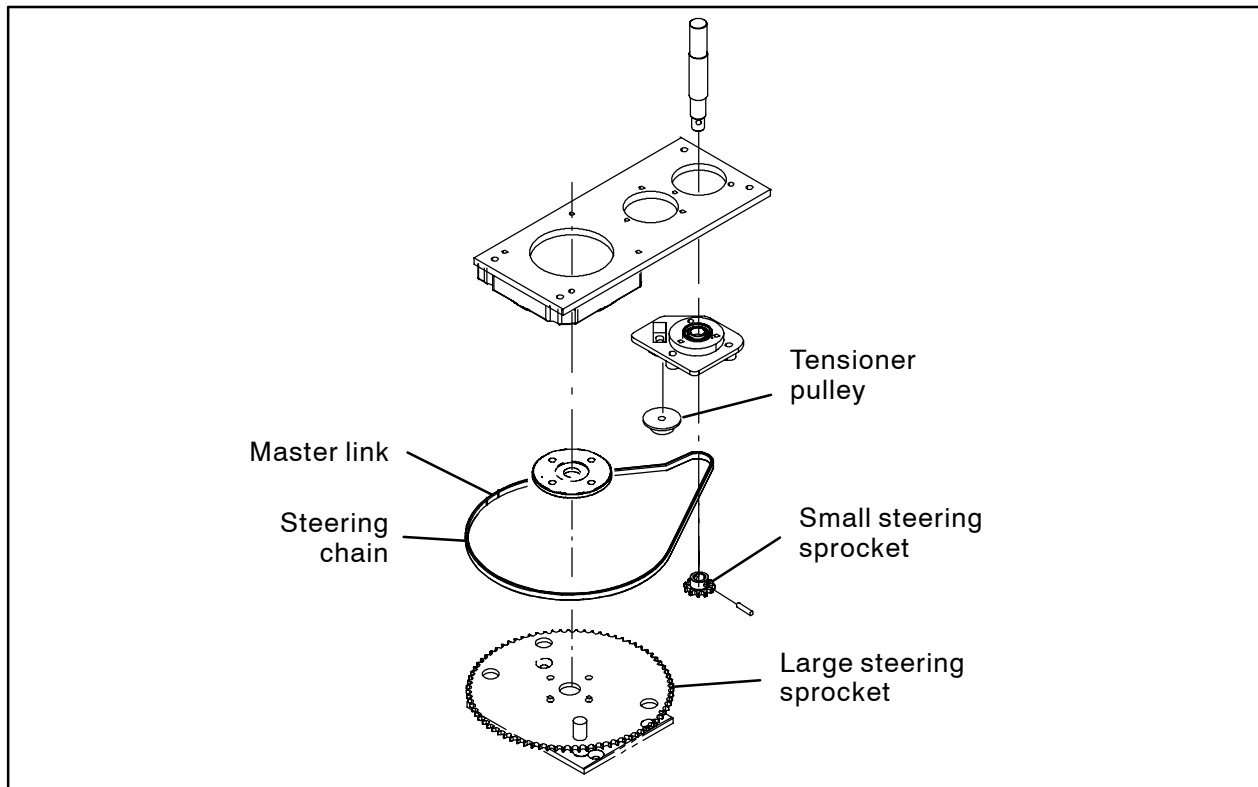

TENNANT COMPANY  
P. O. Box 1452  
Minneapolis, MN 55440-1452